

KITTITAS COUNTY COMMUNITY DEVELOPMENT SERVICES

411 N. Ruby St., Suite 2, Ellensburg, WA 98926
CDS@CO.KITTITAS.WA.US
Office (509) 962-7506
Fax (509) 962-7682

To: Washington State Department of Ecology
Washington State Department of Natural Resources
Washington State Department of Fish & Wildlife
Washington State Department of Transportation
Washington State Department of Health
Kittitas County Sheriff's Department
Kittitas County Board of County Commissioners
Kittitas County Fire District # 7
Kittitas County Environmental Health
Kittitas County Solid Waste Programs
Kittitas County Public Works
Kittitas County Enforcement & Investigation
Cle Elum Roslyn School District 404
Adjacent Property Owners
Applicant

From: Mackenzie Moynihan, Staff Planner

Date: June 2, 2008

Subject: **NOTICE OF PUBLIC HEARING: Schmaus #4 Preliminary Plat (P-07-55)**

Notice is hereby given that the Kittitas County Planning Commission will be conducting an open record public hearing to consider the Schmaus #4 Preliminary Plat, P-07-55, as submitted by Robin and Jayne Schmaus, landowners. The applicants are proposing a 7-lot preliminary plat pursuant to Kittitas County Code 16.32 on approximately 22.95 acres of land that is zoned AG-3. The subject property is located south of Interstate 90, north of Nelson Siding Road, east of Talmadge Road, Cle Elum, WA 98922, and is located in a portion of Section 21, T20N, R14E, WM, in Kittitas County. Map number 20-14-21033-0003.

An open record hearing is scheduled before the Kittitas County Planning Commission on **June 24, 2008**, at 6:30 p.m. in the Commissioner's Auditorium, Kittitas County Courthouse. The Planning Commission at said public hearing will consider written and oral testimony. Interested persons are encouraged to verify with Kittitas County Community Development Services by calling (509) 962-7506 prior to attending.

Project documents may be viewed during normal business hours at Kittitas County Community Development Services (CDS) Office, 411 N. Ruby Street, Ellensburg, WA 98926, or on the CDS website at <http://www.co.kittitas.wa.us/cds/current/>.

Please contact CDS at (509) 962-7506 with any questions you might have. Staff Planner: Mackenzie Moynihan



KITTTITAS COUNTY COMMUNITY DEVELOPMENT SERVICES

411 N. Ruby St., Suite 2, Ellensburg, WA 98926

CDS@CO.KITTTITAS.WA.US

Office (509) 962-7506

Fax (509) 962-7682

Notice of Public Hearing Schmaus #4 Preliminary Plat P-07-55

Notice is hereby given that the Kittitas County Planning Commission will be conducting an open record public hearing to consider the Schmaus #4 Preliminary Plat, P-07-55, as submitted by Robin and Jayne Schmaus, landowners. The applicant is proposing a 7-lot preliminary plat pursuant to Kittitas County Code 16.32 on approximately 22.95 acres of land that is zoned AG-3. The subject property is located south of Interstate 90, north of Nelson Siding Road, east of Talmadge Road, Cle Elum, WA 98922, and is located in a portion of Section 21, T20N, R14E, WM, in Kittitas County. Map number 20-14-21033-0003.

An open record hearing is scheduled before the Kittitas County Planning Commission on **June 24, 2008**, at 6:30 p.m. in the Commissioner's Auditorium, Kittitas County Courthouse. The Planning Commission at said public hearing will consider written and oral testimony. Interested persons are encouraged to verify with Kittitas County Community Development Services by calling (509) 962-7506 prior to attending.

Project documents may be viewed during normal business hours at Kittitas County Community Development Services (CDS) Office, 411 N. Ruby Street, Ellensburg, WA 98926. Related documents may also be viewed on the CDS website at <http://www.co.kittitas.wa.us/cds/current/>. Please contact CDS at (509) 962-7506 with any questions you might have. Staff Planner: Mackenzie Moynihan.

Date: June 2, 2008
Publish: June 2, 2008; Daily Record
June 5, 2008; NKC Tribune

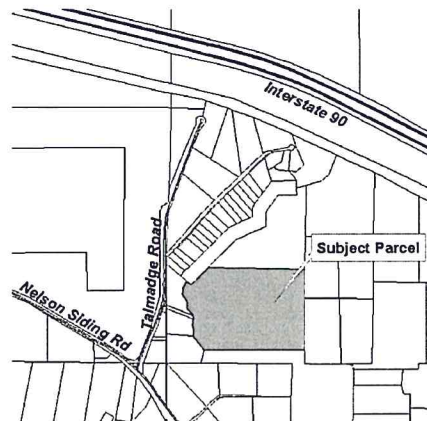

DARRYL PIERCY, DIRECTOR

ALLISON KIMBALL, ASSISTANT DIRECTOR

COMMUNITY PLANNING • BUILDING INSPECTION • PLAN REVIEW • ADMINISTRATION • PERMIT SERVICES • CODE ENFORCEMENT • FIRE INVESTIGATION

26

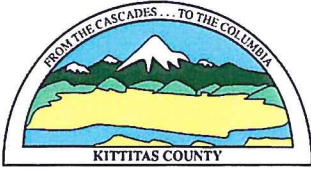

KITTTITAS COUNTY COMMUNITY DEVELOPMENT SERVICES

411 N. Ruby St., Suite 2, Ellensburg, WA 98926

CDS@CO.KITTTITAS.WA.US

Office (509) 962-7506

Fax (509) 962-7682

NOTIFICATION CHECKLIST FOR PLANNING ISSUES

(to be filled out and kept in the files at all times)

PROPOSAL NAME:

Schmaus #4 Preliminary Plat (P-07-55)
Notice of Public Hearing

NOTIFICATION MAIL DATE:

June 2, 2008

Mailer: In addition to attaching copies of the documents mailed, please attach a copy of the names and addresses of those to whom the documents were mailed and of the public hearing notice sent to the newspapers.

State of Washington
County of Kittitas

I certify that the acts of notification of land use action, including those requiring SEPA review, and other actions described in this document have occurred or have been performed.

Staff Signature

Subscribed and sworn to before me this 10 day of June, 20 08.

Notary Public for the State of Washington
residing in Ellensburg

My appointment expires January 9, 20 10.

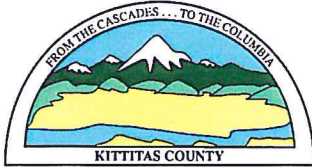

KITTTITAS COUNTY COMMUNITY DEVELOPMENT SERVICES

411 N. Ruby St., Suite 2, Ellensburg, WA 98926

CDS@CO.KITTTITAS.WA.US

Office (509) 962-7506

Fax (509) 962-7682

To: Washington State Department of Ecology
Washington State Department of Natural Resources
Washington State Department of Fish & Wildlife
Washington State Department of Transportation
Washington State Department of Health
Kittitas County Sheriff's Department
Kittitas County Board of County Commissioners
Kittitas County Fire District # 7
Kittitas County Environmental Health
Kittitas County Solid Waste Programs
Kittitas County Public Works
Kittitas County Enforcement & Investigation
Cle Elum Roslyn School District 404
Adjacent Property Owners
Applicant

From: Mackenzie Moynihan, Staff Planner

Date: June 2, 2008

Subject: **NOTICE OF PUBLIC HEARING: Schmaus #4 Preliminary Plat (P-07-55)**

Notice is hereby given that the Kittitas County Planning Commission will be conducting an open record public hearing to consider the Schmaus #4 Preliminary Plat, P-07-55, as submitted by Robin and Jayne Schmaus, landowners. The applicants are proposing a 7-lot preliminary plat pursuant to Kittitas County Code 16.32 on approximately 22.95 acres of land that is zoned AG-3. The subject property is located south of Interstate 90, north of Nelson Siding Road, east of Talmadge Road, Cle Elum, WA 98922, and is located in a portion of Section 21, T20N, R14E, WM, in Kittitas County. Map number 20-14-21033-0003.

An open record hearing is scheduled before the Kittitas County Planning Commission on **June 24, 2008**, at 6:30 p.m. in the Commissioner's Auditorium, Kittitas County Courthouse. The Planning Commission at said public hearing will consider written and oral testimony. Interested persons are encouraged to verify with Kittitas County Community Development Services by calling (509) 962-7506 prior to attending.

Project documents may be viewed during normal business hours at Kittitas County Community Development Services (CDS) Office, 411 N. Ruby Street, Ellensburg, WA 98926, or on the CDS website at <http://www.co.kittitas.wa.us/cds/current/>.

Please contact CDS at (509) 962-7506 with any questions you might have. Staff Planner: Mackenzie Moynihan

DARRYL PIERCY, DIRECTOR

ALLISON KIMBALL, ASSISTANT DIRECTOR

COMMUNITY PLANNING • BUILDING INSPECTION • PLAN REVIEW • ADMINISTRATION • PERMIT SERVICES • CODE ENFORCEMENT • FIRE INVESTIGATION

27

BEPPLE, KEN ETUX
PO BOX 356
TUALATIN OR 97062

ENCOMPASS ENGINEERING &
SURVEYING
108 EAST 2nd STREET
CLE ELUM WA 98922

BROWN, THOMAS E
345 HILL CT
BREMERTON WA 98310-

COOK, HAROLD A
340 SUNSHINE WAY
CLE ELUM WA 98922

DAVIES, LAWRENCE A ETUX
440 SUNSHINE WAY
CLE ELUM WA 98922-

FLORA, CHARLES ETUX
PO BOX 111
EASTON WA 98925

GALLEGOS, RACHAEL
1691 SCOTT DR
CLE ELUM WA 98922

HOVELAND, CATHY
PO BOX 245
SUMNER WA 98390-

JOHNSON, KENT L
1661 HARBOR AVE SW #302
SEATTLE WA 98126-

JTM CORP
PO BOX 458
CLE ELUM WA 98922

KANE, MICHAEL
3815 NE 86TH ST
SEATTLE WA 98115-

KOOB, DARIN R &
ROMAN, WENDY
9805 NE 124TH ST #106
KIRKLAND WA 98034-

LEOPOLD, RYAN S ETUX &
ADAMS, PAUL ETUX
625 13TH AVE W
KIRKLAND WA 98033-

LINK, JEFFREY C ETUX
28137 233RD AVE SE
MAPLE VALLEY WA 98038

MANNING, L. A. ETUX &
SWAN, GARY R. ETUX
600 NW 389TH ST
WOODLAND WA 98674

MARTENS, JERRY T SR ETUX
PO BOX 458
CLE ELUM WA 98922-

MASSA, PAUL M ETUX
1011 CAROL WAY
EDMONDS WA 98020-2940

SCHMAUS, ROBIN A. ETUX
1001 BIG CREEK RD
CLE ELUM WA 98922

SENGSTOCK, FRANK G
4239 S 185TH
SEATTLE WA 98188

SMITH, JOHN D
482 SUNSHINE WAY
CLE ELUM WA 98922

STARR, MARK A ETUX
44228 SE 149TH PL
NORTH BEND WA 98045

THE JTM CO INC
PO BOX 458
CLE ELUM WA 98922-

TURNER, JOSEPH E ETUX
561 STORIE LANE
CLE ELUM WA 98922

Kittitas Reclamation District
PO Box 276
Ellensburg, WA 98926

Kittitas County Fire District # 7
PO Box 777
South Cle Elum, WA 98943

Cle Elum Roslyn School District 404
Administration Office
2690 State Road 903
Cle Elum, WA 98922

Kittitas County Public Works

Kittitas County Environmental Health

Kittitas County Sheriff's Department

Kittitas County Enforcement

Kittitas County Fire Marshal

Kittitas County Board of County
Commissioners

Washington Department of Ecology
Derek Sandison, Regional Director
15 West Yakima Avenue, Suite 200
Yakima, WA 98902

Washington Department of Fish & Wildlife
Brent Renfrow / Mark Teske
201 North Pearl
Ellensburg, WA 98926

Tom Justus
WA State Department of Health
Eastern Regional Office
1500 West Fourth Avenue Suite 305
Spokane, Washington 99201

Kittitas County Solid Waste Programs

DNR
External SEPA Coordinator
P.O. Box 47015
Olympia, WA 98504-7015

WA Dept. of Natural Resources
713 E. Bowers Rd.
Ellensburg, WA 98926

Cindy Preston
DNR Aquatic Land Manager
713 E Bowers Road
Ellensburg, WA 98926

Yakama Nation
P.O. Box 151
Toppenish, WA 98948

Yakama Nation Dept. of Natural Resources
Philip Rigdon
P.O. Box 151
Toppenish, WA 98948

Department of Ecology
Environmental Review Section
PO Box 47703
Olympia, WA 98504-7703

Sean Northrop
206 West 1st
Cle Elum, WA 98922

Yakama Nation
Kate Valdez
Tribal Historic Preservation Officer
PO Box 151
Toppenish, WA 98948

James E Brooks Library
Documents Dept.
400 E. University Way
Ellensburg, WA 98926 MS-7548

Henry Fraser
Yakama Nation Fisheries
MS 7420 CWU
400 E. University Way
Ellensburg, WA 98926

Yakama Nation Cultural Resources Program
Johnson Meninick, Program Manager
PO Box 151
Toppenish, WA 98948

Washington State Department of Archaeology &
Historic Preservation
1063 S. Capitol Way, Suite 106
Olympia, WA 98501

AFFIDAVIT OF PUBLICATION

State of Washington, County of Kittitas, ss: **Diane Ewing** being first duly sworn on oath, deposes and says: That she is the **Office Manager** of the Daily Record, a daily newspaper. That said newspaper is a legal newspaper and has been approved as a legal newspaper by order of the superior court in the county in which it is published and it is now and has been for more than six months prior to the date of the publications hereinafter referred to, published in the English language continually as a newspaper in Ellensburg, Kittitas County, Washington, and it is now and during all of said time printed in an true copy of

NOTICE OF PUBLIC HEARING **Schmaus #4 Preliminary Plat** **P-07-55**

As is published in regular issues (and not in supplement form) of said newspaper once a week for a period of 2 consecutive week(s), commencing on the following days.

JUNE 2, 2008

All dates inclusive and that such newspaper were regularly distributed to its subscribers during all of said period. That the full amount of the fee charged for the foregoing publication is the sum of **\$ 85.74** rate of \$5.10 per column inch for each insertion.

Diane Ewing

Subscribed to me this 9 day of June, 2008.

Patsy A Tenney

PATSY A TENNEY

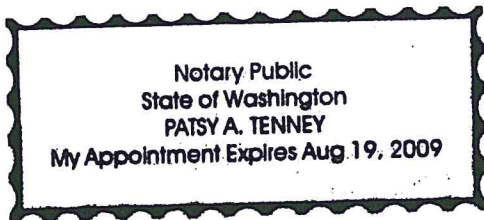

Notary Public in and for
The State of Washington
Residing at Ellensburg,
Washington (SEAL)

**Notice of Public Hearing
Schmaus #4 Preliminary Plat
P-07-55**

Notice is hereby given that the Kittitas County Planning Commission will be conducting an open record public hearing to consider the Schmaus #4 Preliminary Plat, P-07-55, as submitted by Robin and Jayne Schmaus, landowners. The applicant is proposing a 7-lot preliminary plat pursuant to Kittitas County Code 16.32 on approximately 22.95 acres of land that is zoned AG-3. The subject property is located south of Interstate 90, north of Nelson Siding Road, east of Talmadge Road, Cle Elum, WA 98922, and is located in a portion of Section 21, T20N, R14E, WM, in Kittitas County. Map number 20-14-21033-0003.



An open record hearing is scheduled before the Kittitas County Planning Commission on June 24, 2008, at 6:30 p.m. in the Commissioner's Auditorium, Kittitas County Courthouse. The Planning Commission at said public hearing will consider written and oral testimony. Interested persons are encouraged to verify with Kittitas County Community Development Services by calling (509) 962-7506 prior to attending.

Project documents may be viewed during normal business hours at Kittitas County Community Development Services (CDS) Office, 411 N. Ruby Street, Ellensburg, WA 98926. Related documents may also be viewed on the CDS website at <http://www.co.kittitas.wa.us/cds/current/>. Please contact CDS at (509) 962-7506 with any questions you might have. Staff Planner: Mackenzie Moynihan.

Date: June 2, 2008
Publish: June 2, 2008; Daily Record
June 5, 2008; NKC Tribune

03522564		INVOICE		MAKE CHECKS	
CLASS 090		ADTYPE 1E		FOR CLASSIFIED ADVERTISING	
AGATES 11		LINES 57		WORDS 23	
EDITIONS 01		INCHES 8.3		INS. 1	
CUST # A0104728		ADTAKER KA		AMOUNT 255.74	
/509/962-7506		PHONE			
NOTICE OF PUBLIC HEARING		START DATE 08		STOP DATE 08	

11

DAILY RECORD
401 N. Main St. • Ellensburg, WA 98926 • (509) 925-1414

20104728 - 03522564
Kittitas County Community
Development Services
411 N. Ruby St, Suite 2
Ellensburg, WA 98926

INVOICES ARE DUE IN 10 DAYS



Northern Kittitas County Tribune

P.O. Box 308
Cle Elum, WA 98922
(509) 674-2511

Invoice

Bill To:

**Kittitas County Community Development
Services
411 N. Ruby, Suite 2
Ellensburg, WA 98926**

Invoice #: 00053916

Date: 6/5/08

Page: 1

DATE	DESCRIPTION	AMOUNT
6/5/08	Public Hearing June 24 - Schmaus #4 (P-07-55)	\$92.00
		Sales Tax: \$0.00
		Total Amount: \$92.00
		Amount Applied: \$0.00
		<i>Balance Due:</i> \$92.00

RECEIVED
JUN 26 2008
KITTITAS COUNTY
CDS

AFFIDAVIT OF PUBLICATION

STATE OF WASHINGTON)
) SS
COUNTY OF KITTITAS)

JANA E. STONER, being duly sworn on oath, deposes and says that she is the publisher of the *NORTHERN KITTITAS COUNTY TRIBUNE*, a weekly newspaper. That said newspaper is a legal newspaper and has been approved as a legal newspaper by order of the Superior Court in the county in which it is published and it is now and has been for more than six months prior to the date of the publications hereinafter referred to, published in the English language continually as a weekly newspaper in Cle Elum, Kittitas County, Washington, and is now and during all of said time was published in an office maintained at the aforesaid place of publication of said newspaper. That the annexed is a true copy of

Public Hearing -
JUNE 24 - SCHMAUS #4
(P-07-55)

as it was published in regular issues (and not in supplement form) of said newspaper once a

week for a period of ONE consecutive weeks,

commencing on the 5TH day of

JUNE, 2008 and ending on

the 5TH day of JUNE, 2008,

both dates inclusive, and that such newspaper was regularly distributed to its subscribers during all of said period. That the full amount of the fee charged for the foregoing publication is the

sum of \$ 92⁰⁰, which amount has been paid in full.

Jana E. Stoner

Subscribed and sworn to before me this 24th day of

June, 2008.

Ellen I. Schneck

Notary Public in and for the State of Washington, residing at

6 - Cle Elum WA 98943

County of Kittitas. Expires 11/14/08.

**Notice of Public Hearing
Schmaus #4 Preliminary Plat
P-07-55**

Notice is hereby given that the Kittitas County Planning Commission will be conducting an open record public hearing to consider the Schmaus #4 Preliminary Plat, P-07-55, as submitted by Robin and Jayne Schmaus, landowners.

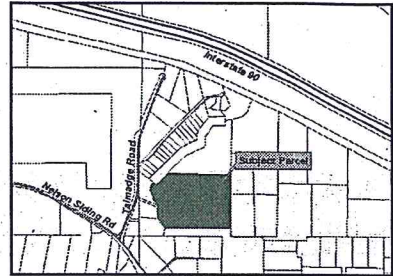

The applicant is proposing a 7-lot preliminary plat pursuant to Kittitas County Code 16.32 on approximately 22.95 acres of land that is zoned AG-3. The subject property is located south of Interstate 90, north of Nelson Siding Road, east of Talmadge Road, Cle Elum, WA 98922, and is located in a portion of Section 21, T20N, R14E, WM, in Kittitas County. Map number 20-14-21033-0003.

An open record hearing is scheduled before the Kittitas County Planning Commission on **June 24, 2008**, at 6:30 p.m. in the Commissioner's Auditorium, Kittitas County Courthouse. The Planning Commission at said public hearing will consider written and oral testimony. Interested persons are encouraged to verify with Kittitas County Community Development Services by calling (509) 962-7506 prior to attending.

Project documents may be viewed during normal business hours at Kittitas County Community Development Services (CDS) Office, 411 N. Ruby Street, Ellensburg, WA 98926. Related documents may also be viewed on the CDS website at <http://www.co.kittitas.wa.us/cds/current/>. Please contact CDS at (509) 962-7506 with any questions you might have. Staff Planner: Mackenzie Moynihan.

Dated: June 2, 2008

(Published in the N.K.C. TRIBUNE, June 5, 2008.)

